

# Product datasheet

Specifications



## Power distribution module. Modicon TM5. for I/O 24 V DC

TM5SPS1

**Price: 1,514.88 ZAR**

### Main

Range Of Product	Modicon TM5
Product Or Component Type	Power distribution module
Product Specific Application	Supply 24 V DC I/O modules

### Complementary

Range Compatibility	Modicon M258 Modicon LMC058
Product Compatibility	Logic controller Motion controller
[Us] Rated Supply Voltage	24 V
Network Type	DC
Current Supplied	10 A for I/O power segment
Maximum Power Dissipation In W	0.8 W
Colour	Grey
Short-Circuit Protection	10 A external fuse
Current Consumption	<= 25 mA 24 V DC
Marking	CE

### Environment

Standards	CSA C22.2 No 142 CSA C22.2 No 213 UL 508 IEC 61131-2
Product Certifications	GOST-R C-Tick cULus CSA
Ambient Air Temperature For Operation	-10...55 °C without derating (horizontal installation) 55...60 °C with derating factor (horizontal installation) -10...50 °C (vertical installation)
Ambient Air Temperature For Storage	-25...70 °C
Relative Humidity	5...95 % without condensation
Operating Altitude	0...2000 m
Storage Altitude	0...3000 m
Vibration Resistance	1 gn at 8.4...150 Hz on DIN rail 3.5 mm at 5...8.4 Hz on DIN rail
Shock Resistance	15 gn for 11 ms

Excluding VAT and subject to change. Please check with your local distributor through "Where to buy"

<b>Resistance To Electrostatic Discharge</b>	4 kV on contact conforming to EN/IEC 61000-4-2 8 kV in air conforming to EN/IEC 61000-4-2
<b>Resistance To Electromagnetic Fields</b>	1 V/m 2...2.7 GHz conforming to EN/IEC 61000-4-3 10 V/m 80...2000 MHz conforming to EN/IEC 61000-4-3
<b>Resistance To Fast Transients</b>	1 kV (I/O) conforming to EN/IEC 61000-4-4 1 kV (shielded cable) conforming to EN/IEC 61000-4-4 2 kV (power lines) conforming to EN/IEC 61000-4-4
<b>Surge Withstand</b>	0.5 kV differential mode conforming to EN/IEC 61000-4-5 1 kV common mode conforming to EN/IEC 61000-4-5
<b>Electromagnetic Compatibility</b>	EN/IEC 61000-4-6
<b>Disturbance Radiated/Conducted</b>	CISPR 11

## Packing Units

<b>Unit Type Of Package 1</b>	PCE
<b>Number Of Units In Package 1</b>	1
<b>Package 1 Height</b>	2.000 cm
<b>Package 1 Width</b>	6.000 cm
<b>Package 1 Length</b>	10.600 cm
<b>Package 1 Weight</b>	35.000 g
<b>Unit Type Of Package 2</b>	S02
<b>Number Of Units In Package 2</b>	97
<b>Package 2 Height</b>	15.000 cm
<b>Package 2 Width</b>	30.000 cm
<b>Package 2 Length</b>	40.000 cm
<b>Package 2 Weight</b>	3.847 kg

## Contractual warranty

<b>Warranty</b>	18 months
-----------------	-----------

## Sustainability

**Green Premium™ label** is Schneider Electric's commitment to delivering products with best-in-class environmental performance. Green Premium promises compliance with the latest regulations, transparency on environmental impacts, as well as circular and low-CO<sub>2</sub> products.

**Guide to assessing product sustainability** is a white paper that clarifies global eco-label standards and how to interpret environmental declarations.

[Learn more about Green Premium >](#)

[Guide to assess a product's sustainability >](#)



Transparency RoHS/REACH

## Well-being performance

Toxic Heavy Metal Free

Mercury Free

Rohs Exemption Information Yes

Pvc Free

## Certifications & Standards

**Reach Regulation** [REACH Declaration](#)

**Eu Rohs Directive** Pro-active compliance (Product out of EU RoHS legal scope)

**China Rohs Regulation** [China RoHS declaration](#)

**Environmental Disclosure** [Product Environmental Profile](#)

**Weee** The product must be disposed on European Union markets following specific waste collection and never end up in rubbish bins

**Circularity Profile** [End of Life Information](#)

Dimensions Drawings

TM5 Slice

---

Dimensions

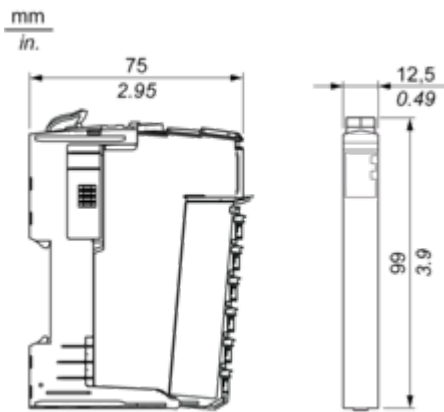

Mounting and Clearance

TM5 System

---

Spacing Requirements

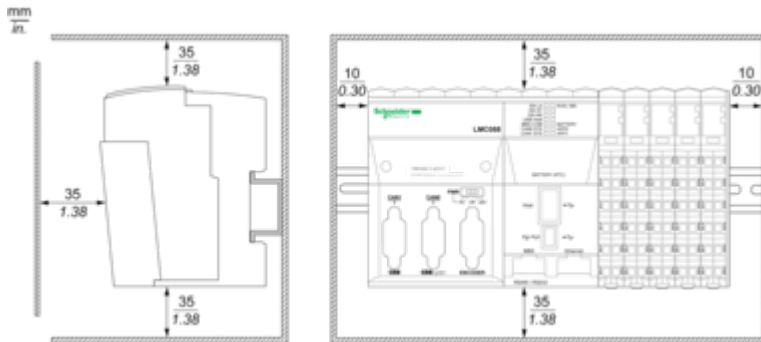

Mounting on a DIN Rail

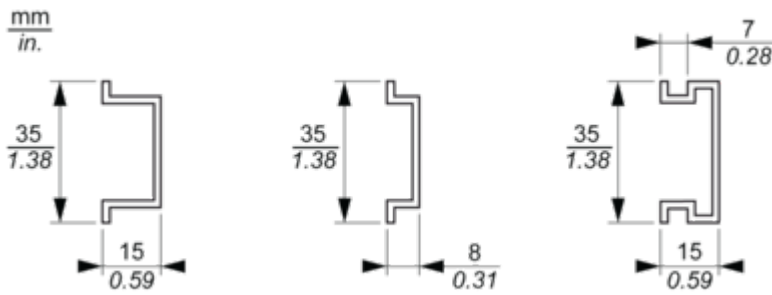





Connections and Schema

**TM5 System Wiring Recommendations**

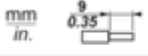
---

**Wire Sizes to Use with the Removable Spring Terminal Blocks**

 mm in.				
mm <sup>2</sup>	0,08...2,5	0,25...2,5	0,25...1,5	2 x 0,25...2 x 0,75
AWG	28...14	24...14	24...16	2 x 24...2 x 18

PDM Electronic Module 24 Vdc I/O

---

Wiring Diagram

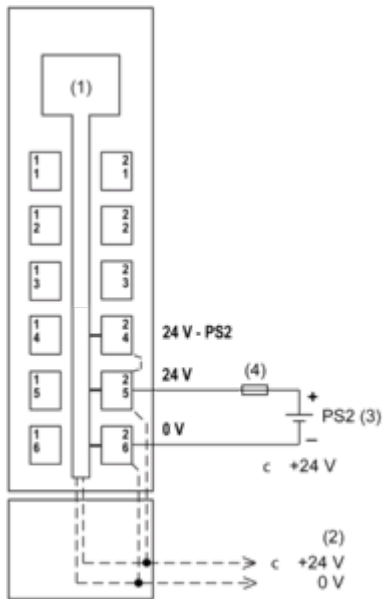

- (1) Internal electronics
- (2) 24 Vdc I/O power segment integrated into the bus bases
- (3) PS2: External isolated SELV power supply 24 Vdc limited to 200 VA for UL508 conformance, or limited to 150 VA for CSA 22.2, N° 142
- (4) External fuse type T slow-blow 10 A max. 250 V